

10TH & 11TH FLOOR PLAN

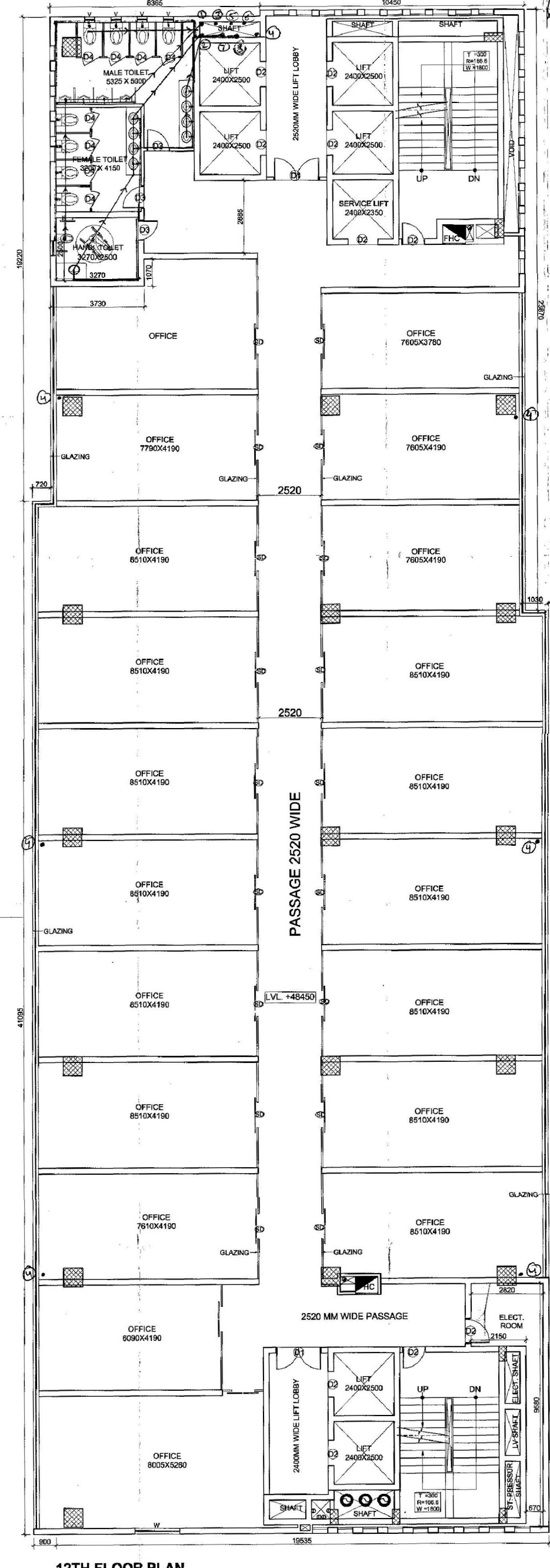

12TH FLOOR PLAN

1. = 100 φ S.W.P.
2. = 100 φ S.V.P.
3. = 75 φ ASP
4. = 100 φ RWP
5. = DWS RIVER
6. = FWS RIVER
7. = DWS SUPPLY
8. = FWS SUPPLY

SCHEDULE OF DOOR-WINDOW			
NO.	WIDTH	HEIGHT	CELL/LINTEL LVL.
D	1000	2400	1100
D1	1600	2400	1100
D2	1600	2400	1100
D3	1600	2100	1100
D4	700	2100	1100
V1	600	800	1000
V2	600	800	1000
V3	1000	1500	900
V4	1000	1500	900
V5	1000	1500	900
V6	1000	1500	900

PROPOSED BUILDING PLAN OF COMMERCIAL COLONY ON THE LAND MEASURING 3.24722 ACRES (LICENCE NO. 56 OF 2012 DATED 06-06-2012) IN SECTOR-78, DISTT. - GURGAON MANESAR URBAN COMPLEX BEING DEVELOPED BY ISHAN SINGH IN COLLABORATION WITH SPAZE TOWERS PVT. LTD.

REVISIONS

NO.	DESCRIPTION	DATE
1	10TH FLOOR	10/07/2018
2	11TH FLOOR	10/07/2018
3	12TH FLOOR	10/07/2018

ARCHITECT'S SIGN. \_\_\_\_\_ OWNER/AUTH. SIGN. \_\_\_\_\_

ARCHITECTS: **Secudeta Consultants**  
PUNJAB TOWNSHIP, 3RD FLOOR, S.C.O. 85/81 OLD JUDICIAL COMPLEX  
CIVIL LINES, GURGAON,  
TELEPHONE: 4199022  
E-MAIL: secudeta@gmail.com

11TH FLOOR - INTERNAL CHANGES DONE WITHOUT SANCTIONS - SHOWN IN BLUE COLOUR					
NO.	COEFF.	LENGTH	BREADTH	NOS.	AREA (SQ.M)
1		5.915	6.230	1	37.205
2		13.855	12.930	1	179.145
3		5.005	11.260	1	56.356
4		19.580	13.250	1	259.437
5		20.480	27.595	1	565.146
TOTAL INTERNAL CHANGED AREA					1097.289

- ADDED AREA WITHOUT SANCTION
- INTERNAL CHANGE

NOTES:

- ALL LIFT SHALL HAVE TEN POWER BACK-UP
- THE BUILDING SHALL BE FULLY AIR-CONDITIONED & MECHANICALLY VENTILATED
- ALL ELECTRICAL INSTALLATIONS SHALL BE AS PER PROVISIONS OF NBC
- FIRE FIGHTING: SAFETY PROVISIONS SHALL BE AS PER RELEVANT NBC PROVISIONS
- RESIDENTIAL AREAS SHALL HAVE MECHANICALLY VENTILATED AS PER RELEVANT CODE
- ALL TOILETS AND VENTILATES AS PER HANDBOOK BUILDING CODE 2017
- BUILDING HAS AUTOMATIC SPRINKLER SYSTEM WHEREVER REQUIRED BY NBC
- BUILDING WILL BE DESIGNED TO RESIST COLLAPSE AS PER RELEVANT IS CODE FOR EARTHQUAKE RESISTANCE
- THE RESPONSIBILITY OF STRUCTURE DESIGN AND STRUCTURE STABILITY OF BUILDING AGAINST THE EARTHQUAKE SHALL BE ENTIRELY OF THE STRUCTURE ENGINEER/ARCHITECT/TOWNER
- THE RAIN WATER DRAINAGE SYSTEM SHALL BE PROVIDED AS PER GENERAL DRAINAGE WATER
- GLASS PANELS OF REQUIRED CAPACITY SHALL BE PROVIDED ON ROOF TOP AS PER
- THE COLLECTOR/CONCRETE SHALL USE ONLY LIGHT-GARTING CODES (APPROVED) FITTING FOR INTERNAL LIFTING AS WELL AS CAPABLE LIFTING
- ALL HANDS OF PAINTS WITH LEADING

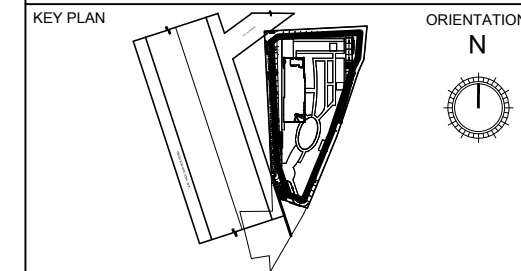

PRINCIPAL ARCHITECT: **ACPL** Architecture Management Planning

ACPL Design Ltd

PROJECT:

REVISED BUILDING PLAN OF COMMERCIAL COLONY ON THE LAND MEASURING 3.24722 ACRES (LICENCE NO. 56 OF 2012 DATED 06-06-2012) IN SECTOR-78, DISTT. - GURGAON MANESAR URBAN COMPLEX BEING DEVELOPED BY ISHAN SINGH IN COLLABORATION WITH SPAZE TOWERS PVT. LTD.

OWNER/AUTH. SIGNATURE \_\_\_\_\_ ARCHITECT'S SIGNATURE \_\_\_\_\_

DRAWING TITLE: **ELEVENTH FLOOR PLAN (SERVICE FLOOR)**

DRAWING NO: **AD-08** SCALE: **1:200**